

**KEY**

- **PROPOSED NO WAITING AT ANY TIME**
- - - **PAY & DISPLAY PARKING MONDAY-FRIDAY 08.30-20.00 NO TIME LIMIT**
- - - **PARKING PERMIT HOLDERS ONLY MONDAY-SUNDAY 08.30-20.00**
- ◆ **PROPOSED LOCATION OF PARKING METER**

Notes

Rev.	Description	Drwn	Sig.	Date	Chkd	Sig.	Date	Appr	Sig.	Date

Rev.	Description	Drwn	Sig.	Date	Chkd	Sig.	Date	Appr	Sig.	Date

Scale 1:1250

North Point

Based upon the Ordnance Survey mapping with the permission of the Controller of Her Majesty's Stationery Office. Crown copyright. Unauthorised reproduction infringes Crown copyright and may lead to prosecution or civil proceedings. Surrey County Council LA 076872 1996.

Drawn by	CAH	Sig.	CAH	Date	11/11
Checked by	RH	Sig.	RH	Date	11/11
Approved by	DC	Sig.	DC	Date	11/11

Project

**WAVERLEY DPE HASLEMERE**

Drawing

**IMPLEMENTED TRAFFICORDERS LOCATION OF PAYMENT MACHINES AND BAYS**

SHEET OF

Project No. 3282/WAV

Contract Sheet No. 24127

Rev. -

Classification ADVERTISED

**KEY**

- **PROPOSED NO WAITING AT ANY TIME**
- PA - **PAY & DISPLAY PARKING MONDAY-FRIDAY 08.30-20.00 NO TIME LIMIT**
- PH - **PARKING PERMIT HOLDERS ONLY MONDAY-SUNDAY 08.30-20.00**
- **PROPOSED LOCATION OF PARKING METER**
- **EXISTING WAITING, LOADING AND PARKING RESTRICTIONS (WITH OR WITHOUT SYMBOLS)**

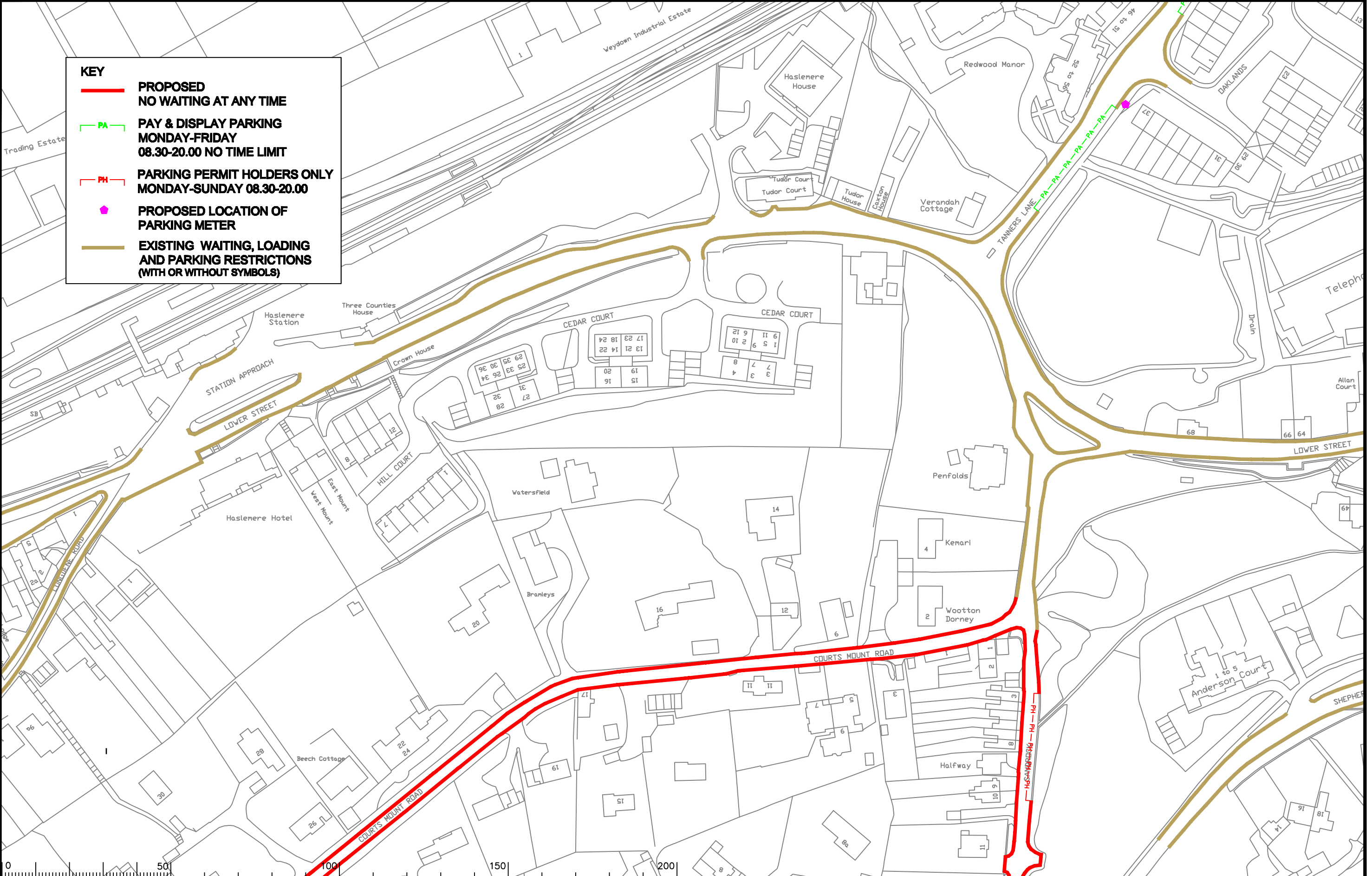

Notes

Rev.	Description	Drwn	Sig.	Date	Chkd	Sig.	Date	Appr	Sig.	Date
A	RESTRICTIONS AMENDED	CAH	CAH	09.11	JAR	JAR	09.11	DC	DC	09.11

North Point

Based upon the Ordnance Survey mapping with the permission of the Controller of Her Majesty's Stationery Office. Crown copyright. Unauthorised reproduction infringes Crown copyright and may lead to prosecution or civil proceedings. Surrey County Council LA 076872 1996.

Drawn by SDC Sig. SDC Date 03/07

Checked by originator TPC Sig. TPC Date 03/07

Approved by TPC Sig. TPC Date 03/07

Project

**WAVERLEY DPE HASLEMERE**

**IMPLEMENTD TRAFFIC ORDERS**

SHEET OF

**SURREY COUNTY COUNCIL**  
Sustainable Development  
Head of Transportation  
SA Ltd  
Method of Work: SA 100

Project No. 3282/WAV

Contract Sheet No. 24.053 Rev. A

Classification: ADVERTISED



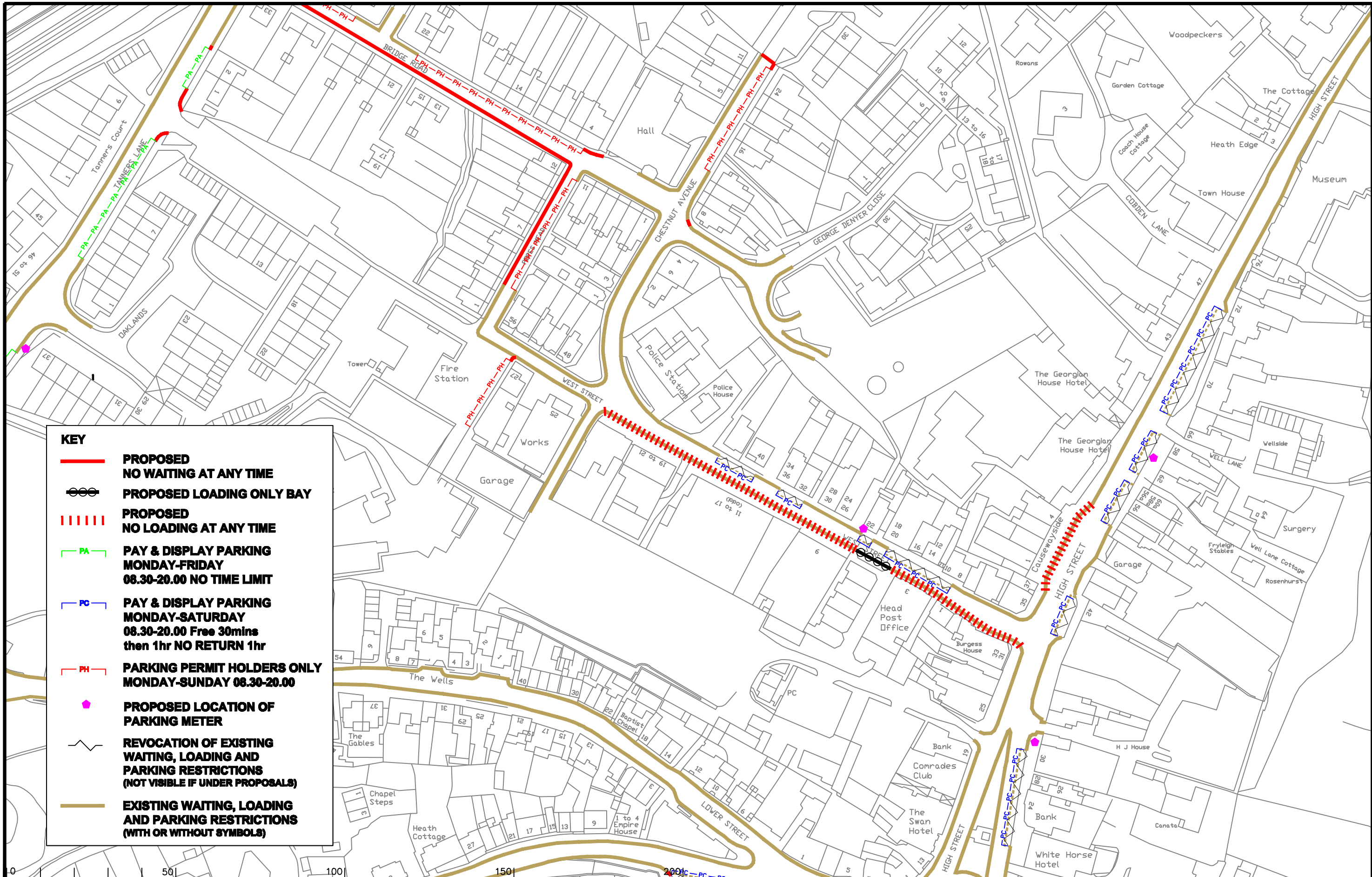

**KEY**

- **PROPOSED NO WAITING AT ANY TIME**
- PROPOSED LOADING ONLY BAY**
- ||||| **PROPOSED NO LOADING AT ANY TIME**
- PA — **PAY & DISPLAY PARKING MONDAY-FRIDAY 08.30-20.00 NO TIME LIMIT**
- PC — **PAY & DISPLAY PARKING MONDAY-SATURDAY 08.30-20.00 Free 30mins then 1hr NO RETURN 1hr**
- PH — **PARKING PERMIT HOLDERS ONLY MONDAY-SUNDAY 08.30-20.00**
- **PROPOSED LOCATION OF PARKING METER**
- REVOCAION OF EXISTING WAITING, LOADING AND PARKING RESTRICTIONS (NOT VISIBLE IF UNDER PROPOSALS)**
- **EXISTING WAITING, LOADING AND PARKING RESTRICTIONS (WITH OR WITHOUT SYMBOLS)**

Notes

Rev.	Description	Drwn	Sig.	Date	Chkd	Sig.	Date	Appr	Sig.	Date
A	SYMBOLS ADDED TO RESTRICTIONS	SDC	SDC	23.01.08	TPC	TPC	23.01.08	TPC	TPC	23.01.08
B	TANNERS LANE AND BRIDGE ROAD RESTRICTIONS ADDED	SDC	SDC	13.11.08	TPC	TPC	13.11.08	TPC	TPC	13.11.08
C	RESTRICTIONS ADDED/AMENDED	GAH	GAH	06.10	JAR	JAR	06.10	TPC	TPC	06.10
C	RESTRICTIONS ADDED/AMENDED	GAH	GAH	09.11	JAR	JAR	09.11	TPC	TPC	09.11

Drwn by	Sig.	Date	Checked by	Sig.	Date	Approved by	Sig.	Date
SDC	SDC	03.07	TPC	TPC	03.07	TPC	TPC	03.07
TPC	TPC	03.07	TPC	TPC	03.07	TPC	TPC	03.07
TPC	TPC	03.07	TPC	TPC	03.07	TPC	TPC	03.07

Scale 1:1250

Based upon the Ordnance Survey mapping with the permission of the Controller of Her Majesty's Stationery Office. Crown copyright. Unauthorised reproduction infringes Crown copyright and may lead to prosecution or civil proceedings. Surrey County Council LA 076872 1998.

North Point

Project: **WAVERLEY DPE HASLEMERE**

Drawing: **IMPLEMENTED TRAFFIC ORDERS**

Project No. 3282/WAV

Contract Sheet No. 24054

Revision: D

Classification: ADVERTISED

**SURREY COUNTY COUNCIL**  
Sustainable Development

Head of Transportation  
SA Ltd  
Method 4047 City Size Part